



RESIDENTIAL PLASTIC SEATS



1900CCP

Seats shall be No. 1900CCP as manufactured by Bemis Manufacturing Co. Seats shall be medium weight and injection molded of solid plastic. Seats shall be closed front with cover for elongated bowl and feature large molded-in bumpers. Chrome-plated brass hinges with 300 series stainless steel pintles. The molded-in bumpers provide easy cleaning. Color to be white.

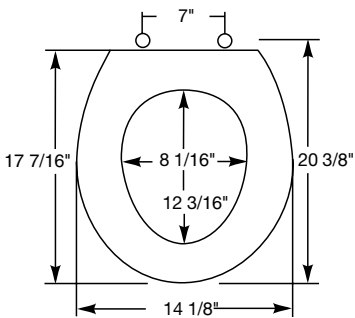

Ring thickness is 11/16"
Ring thickness including the bumper is 1"
Height of the seat with cover is 1-1/2"



CHROME-PLATED
BRASS HINGE



7" CENTERS BOLT INTO
TANK ADAPTED FOR THE
CASE 1100



1900CCP PROFILE