



R E S I D E N T I A L P L A S T I C S E A T S



## 1100TT

Seats shall be No. 1100TT as manufactured by Bemis Manufacturing Co. Seats shall be heavy weight and injection molded of solid plastic. Seats shall be closed front with cover for elongated bowl and feature large molded-in bumpers. Color-matched Top-Tite® hinges contain stainless steel pintles, non-corrosive top-tightening bolts, wing nuts and no-slip washers. The "locked-in" Top-Tite® hinge design will prevent wobbling. The molded-in bumpers provide easy cleaning. Color to be \_\_\_\_\_. (specify white or fixture manufacturer's color.)

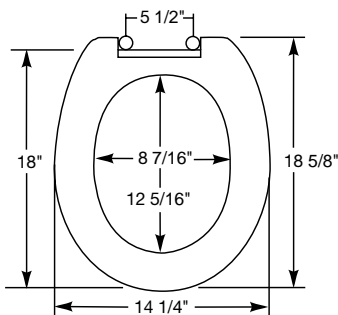

TOP-TITE® HINGES  
FEATURE  
NO-SLIP WASHER



"LOCKED-IN"  
TOP-TITE® HINGE

Ring thickness is  $\frac{13}{16}$ "  
Ring thickness including the bumper is  $1\frac{1}{16}$ "  
Height of the seat with cover is  $2\frac{5}{16}$ "